

2 4G LED RGB Controller



Main Characteristics

V3 RF RGB Remote Control

Remote Option: RGB
 Working Voltage: 3Vdc (Battery CR2032)
 Wireless Frequency: 2.4GHz
 Working Temperature: -30 ~55
 Package Size: L150xW46xH18(mm)
 Weight(G.W.): 85g

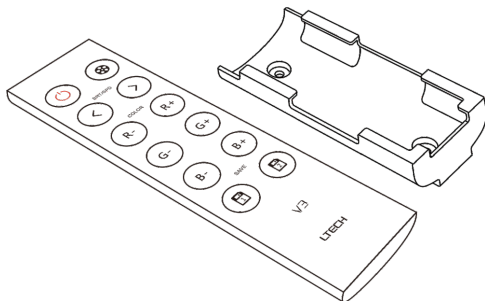

R4-3A CV Receiver

Input Voltage: 5-24Vdc
 Max Current Load: 3A x 4CH Max. 12A
 Max Output Power: 60W/144W/288W(5V/12V/24V)
 Working Temperature: -30 ~55
 Package Size: L127xW35xH24(mm)
 Weight(G.W.): 60g

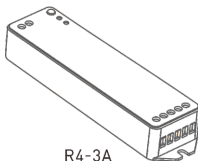

R4-3A

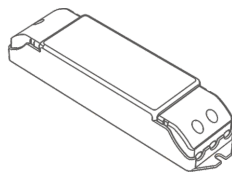

R4-5A/R4-CC

R4-5A CV Receiver

Input Voltage: 5-24Vdc
 Max Current Load: 5A x 4CH Max. 20A
 Max Output Power: 100W/240W/480W(5V/12V/24V)
 Working Temperature: -30 ~55
 Package Size: L178xW48xH33(mm)
 Weight(G.W.): 150g

Note: Receiver is sold separately.

R4-CC CC Receiver

Input Voltage: 12-48Vdc
 Output Voltage: 3-46Vdc
 Output Current: CC 350/700/1050mA x 4CH
 Output Power: 1.05W-48.3W x 4CH Max 193.2W
 Working Temperature: -30 ~55
 Package Size: L178xW48xH33(mm)
 Weight(G.W.): 165g

Dimensions

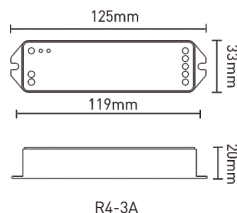
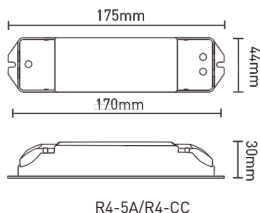
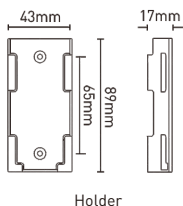
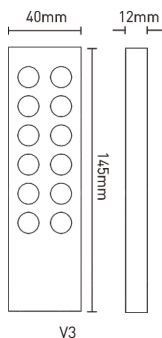

Operating Instruction for Remote:

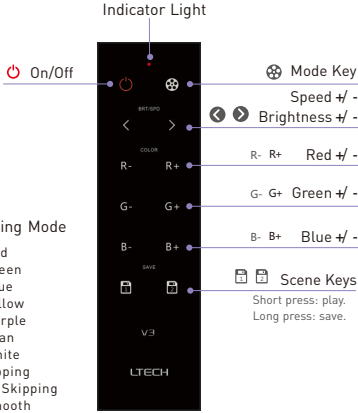

Match/Clear code between remotes

Match code:

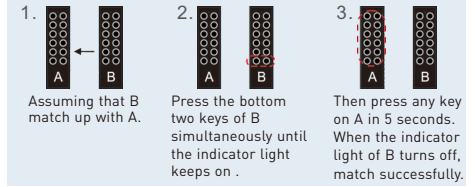

Clear code:

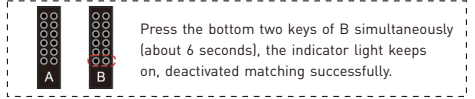

Match/Clear code between remote and receiver

Match code:

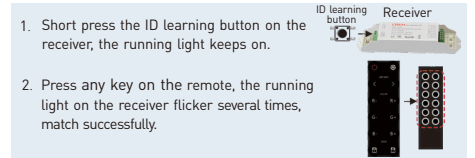

Clear code:

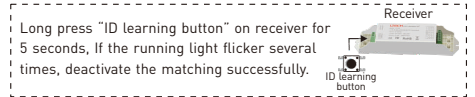

Operating Instruction for Receiver:

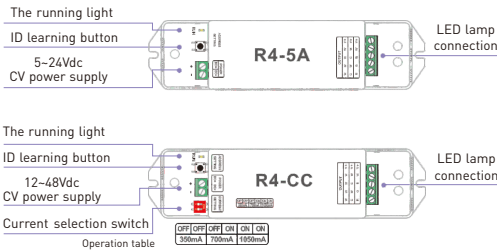

Wiring Diagram :

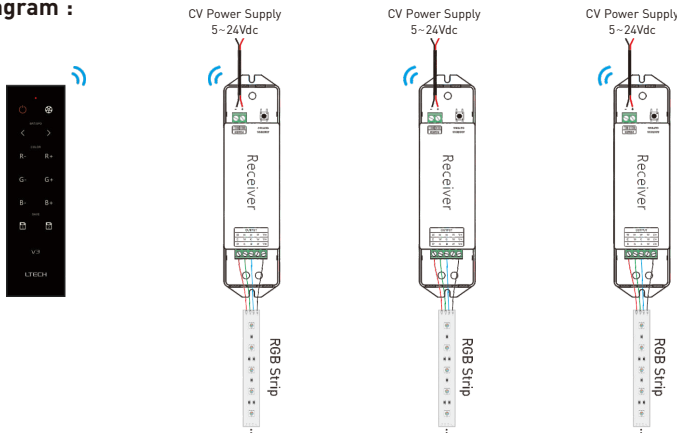

Attention:

- Please replace the battery if the remote becomes insensitive or control distance is shortened.
- Please take out the battery for long time unused.